

29 October, 2008

To all students

Notice regarding the installation of earthquake warning devices

Devices providing emergency notices of earthquakes have been installed at Nanzan University to ensure the safety of our students and to help prevent damage caused by earthquakes. Only a few seconds of prior warning can be given before a strong tremor, so we need to be mentally prepared to take appropriate action in that short time to protect ourselves from harm.

1. What to do if you hear or see an earthquake warning

- (1) When you hear an earthquake warning, your personal safety must be your first priority.
- ⊙ Do not panic and run outside if you are inside a classroom or dining room, instead protect your head by seeking shelter under a desk in preparation for the tremor.
 - ⊙ If you are in a gymnasium, hallway or on a staircase and there is nowhere readily available for you to take shelter from falling objects, watch out for falling glass or other objects and get ready for the tremors.
 - ⊙ Move away from shelves if you are in library or similar room.
 - ⊙ If you are outdoors, move away from buildings and get ready for the tremors.
 - ⊙ If you are in the pool, get out immediately and get ready for the tremors. Be particularly wary of falling glass from either side of the pool.
- (2) Once the tremors have stopped, follow the designated path and assemble in the evacuation area.
- ⊙ If the warning is given during class time, teaching staff will guide students out of the classroom to the evacuation area.
- (3) After evacuating and confirming that everyone is safe, please wait at the evacuation area until the Disaster Countermeasure Office issues further instructions.
- ⊙ Wait for instructions concerning classes recommencing, being cancelled or for students to return home.

2. Evacuation routes

Please check material provided separately to confirm your understanding of evacuation routes and evacuation areas for each campus.

3. Date of commencement of the warning system

1 November, 2008 (Saturday)

4. Relevant webpage

Meteorological Agency (when you have heard or seen an earthquake warning) →
<http://www.seisvol.kishou.go.jp/eq/EEW/kaisetsu/knowledge/index.html>

Nagoya Campus Student Affairs Office
Seto Campus No. 2 Department

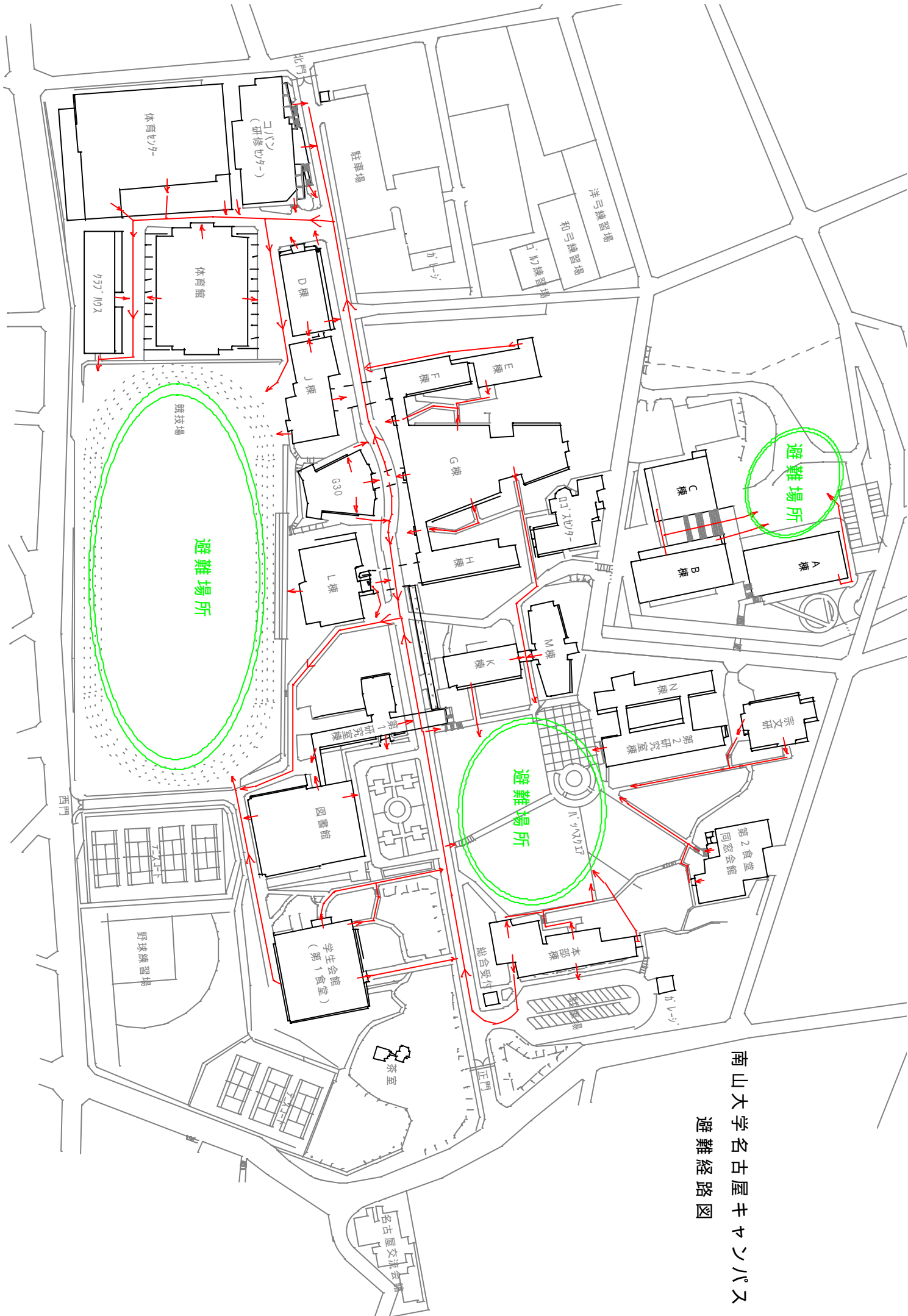

南山大学名古屋キャンパス
避難経路図

正門 正門

高校自動車

避難経路図 避難場所(バス停・芝生広場・グラウンド)

駐車場

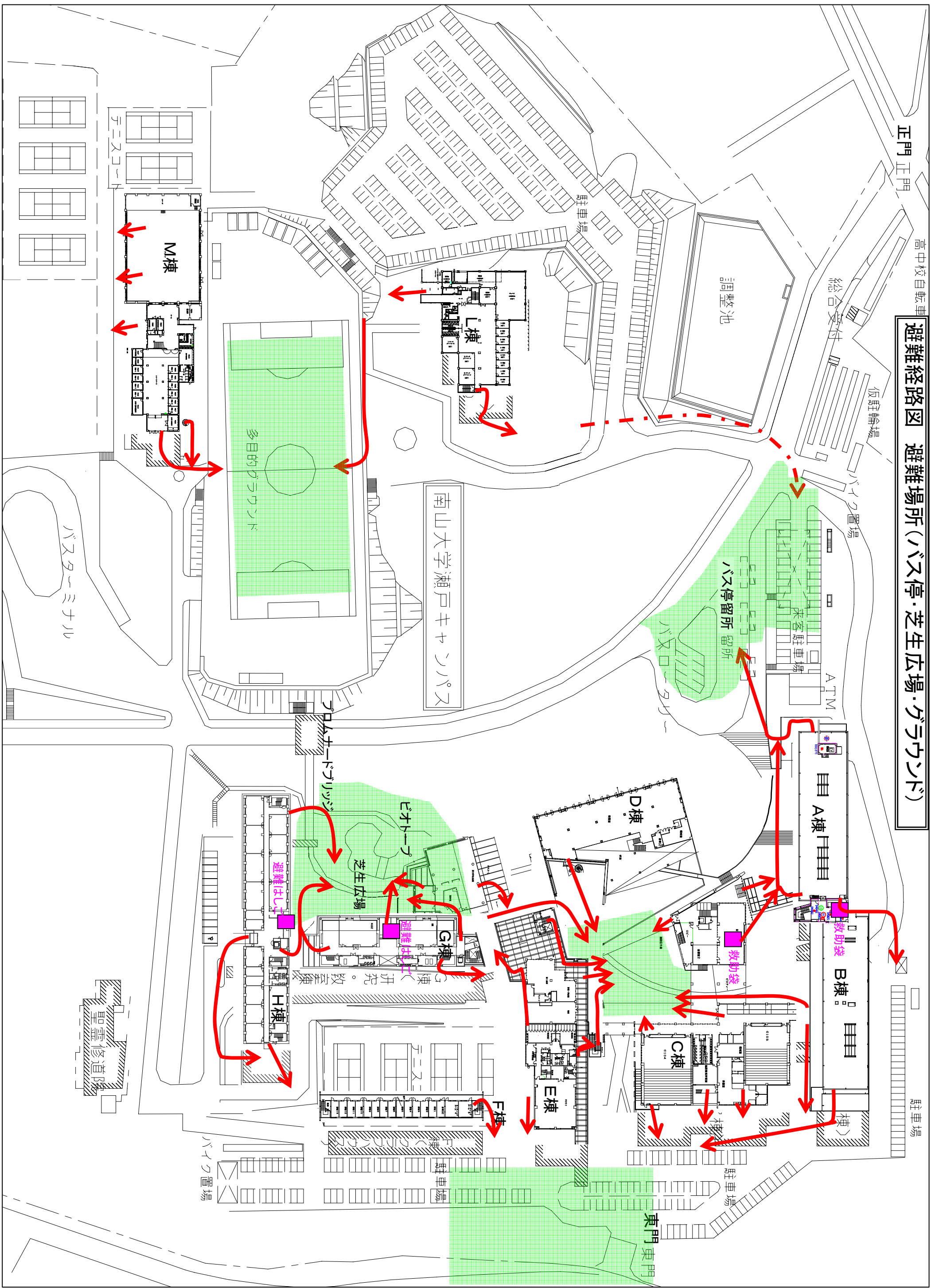

仮駐輪場

バイク置場

総合受付

深谷駐車場

ATM

バス停留所

バス

南山大学瀬戸キャンパス

プロナードブリッジ

芝生広場

避難はしご

避難はしご

救助袋

救助袋

東門 東門

バイク置場

バスターミナル

テニスコート

M棟

L棟

多目的グラウンド

D棟

A棟

B棟

C棟

E棟

F棟

H棟

G棟

聖霊修道院